



MEDICAL COACHES

World-Class Craftsmanship
Worldwide Reputation

ENERGISTX 1012 Third St Santa Cruz CA 95060
Ph: 831 423 6363 FAX 831 423 6363

Email: info@energistx.com

Visit: <http://www.energistx.com>

SIEMENS biograph Mobile PET/CT



Basic Specifications:

- Length: 46' (14.0M)
- Width: 102" (10.1M)
- Height: 13'5" (4.05M)
- Rear Axle: 35,000 lbs. (15,909kg)
- Total Wt.: 57,000lbs. (25,909kg)
- Power Input: 480V, 3ph 60Hz 150A
- Generator: 70kw Diesel-Side Skirt Compartment
- HVAC: 108,000 Cool/18kw heat

Standard Features:

- Expandable Sides, Dual 14' X 2'
- All Aluminum Body, Monocoque Aircraft-Style
- Custom Built Steel Chassis for Extra Rigidity
- Air Suspension on all Axles And Fifth Wheel
- Rivetless 0.80" Side Panels, 60% Thicker than most Mobiles
- Front Hydraulic Leveling Jacks, Electrical Level Indicators
- Rear Stanchions, Stored in Skirt Compartment
- Exterior Compartments are Rust and Leak Free with Electric, Keyless Locks
- 70kw Diesel Generator, Installed in Protected Side Compartment. Conveniently Serviced.
- Powers Trailer and PET/CT Systems
- 100 Gallon Fuel Tank
- Hydraulic Patient Lift Mounted in Protected Side Compartment, with Emergency Hand Pump
- Electric Roll Up Door, with Safety Hand Crank
- Canopy/Door Covers Roll Door In Transit.
- Protects Patient Lift at Site
- Central Power Switch Controls.
- Safe and Conveniently Located Inside Trailer
- 50' Shore Cable, Accessible from Both Sides
- Easy Slide Entrance Steps and Platform are Self Storing
- All Metal Ceiling, Easy to Clean and Access
- Air Distribution "Soft Flow" Curtain Effect
- Hot Lab Room Front Area (Cabinets and Equipment Optional)
- Two Separate Patient Prep Areas
- Control Room With Full Counter And Cabinets
- Two Phone Lines and Three Data Lines
- Scan Room Access Thru Sliding Leaded Door
- Lead Lining Provided as required
- European-Style Cabinetry with Push Button Latches
- Emergency Lights, Built In
- Dimmable, Low Density Console Lighting
- Towable by Standard Tractor

Options:

- Hot Lab Cabinets and Equipment
- Sink in Scan Room
- Emergency Exit
- Auto Transfer Switch
- Custom Lettering and Artwork

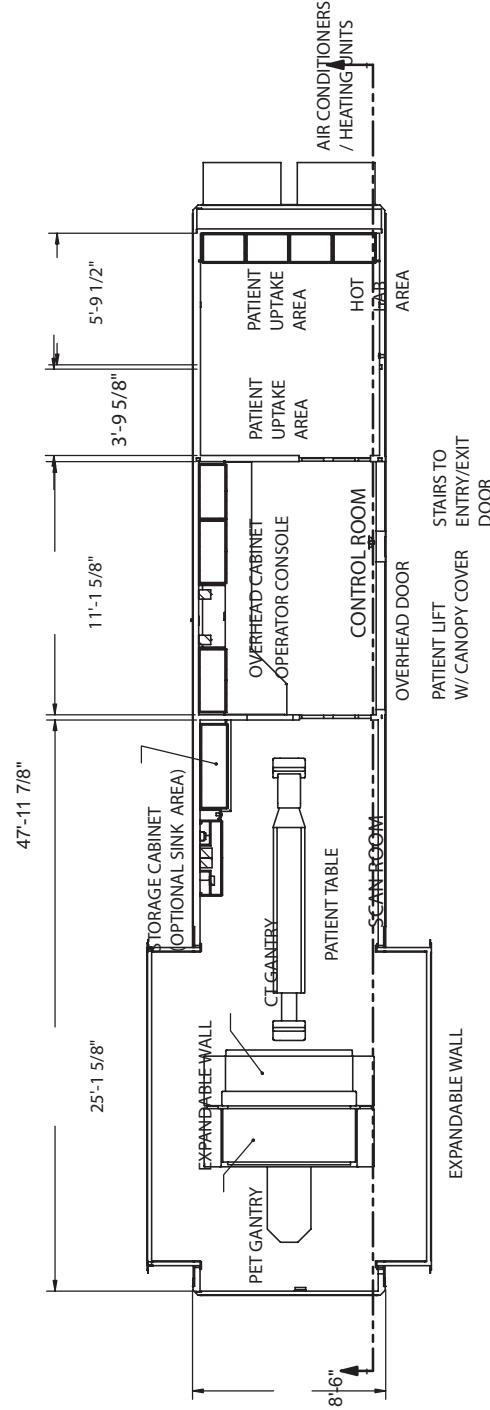
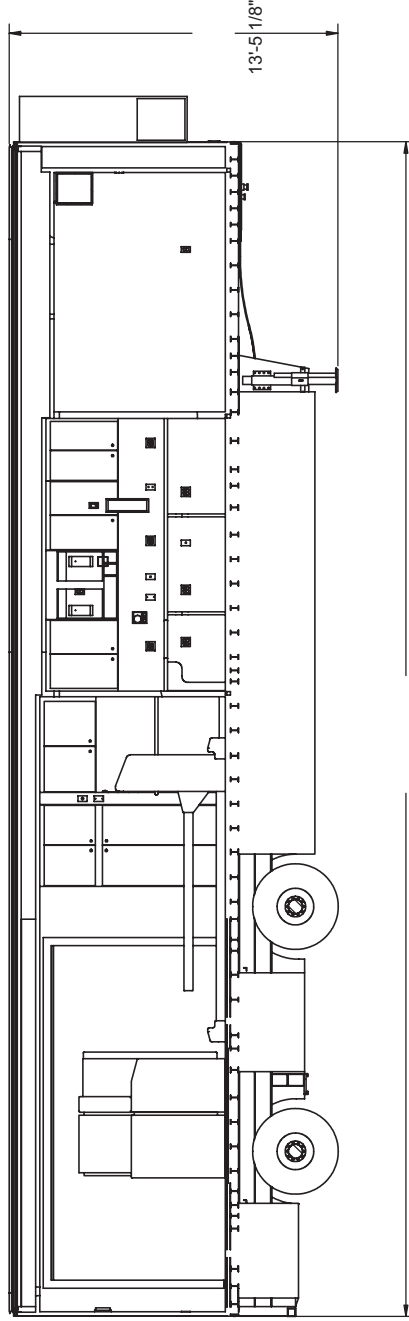

*Medical Coaches is in a continual process of product improvement and reserves the right to change specifications without notice. rev.0102