



Disaster Relief Unit (DRU)

International Disaster Services



The Disaster Relief Unit, or DRU for short, is a temporary housing and utility unit designed for immediate deployment after disasters. It can be delivered quickly and installed virtually anywhere. The unit is constructed from 40' trans-modal cargo containers, giving it strength, durability, and ease of transport.

Our goal at International Disaster Services, LLC is to provide our clients' employees a safe, climate-controlled self-contained living space for their missions. We understand that hospitable living conditions are tantamount to retaining a trained workforce, while also understanding you have limited valuable resources.

These units are designed to operate with conventional utilities or in remote or disaster affected areas. It can operate on backup systems such as generators for electric and roof top cisterns for water. The ability to operate on conventional power, water, and waste systems means that the units can be used to house workers or evacuees in non-affected areas as well.

The units are designed with an adjustable goose neck that also has a pintle hook option. This allows the units to be pulled by a truck with the proper equipment or a standard tractor trailer. They can remain on wheels or be set on the ground in under 30 minutes on a foundation with ability to be mobile again very quickly. This great flexibility allows for many logistical options. IDS can provide transportation or customers have the option of moving the units themselves.

IDS has a variety of designs which can meet virtually any need. From mobile offices, temporary bunk facilities, dormitory units, residential models, shower, bathroom, and many other floor plans, the DRU construction allows for a wide array of standard options that can meet many needs.

In the next few pages, we will discuss a small sampling of our products. Please feel free to ask questions regarding them. Our knowledgeable and helpful sales team will be happy to answer any question.

ENERGISTX
71012 Third Street
Santa Cruz, California
95060
Phone: 831 423 6363
866-733-8686
Fax: 831-423-9331

Halle Blessing
CEO
blessing@energistx.com





Our 28,000 square foot facility is specially designed for the quick manufacture of the Disaster Relief Unit. With on-site metal fabrication, painting, plumbing, framing, and finishing, IDS can quickly manufacture any unit in our inventory.

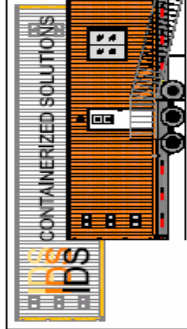
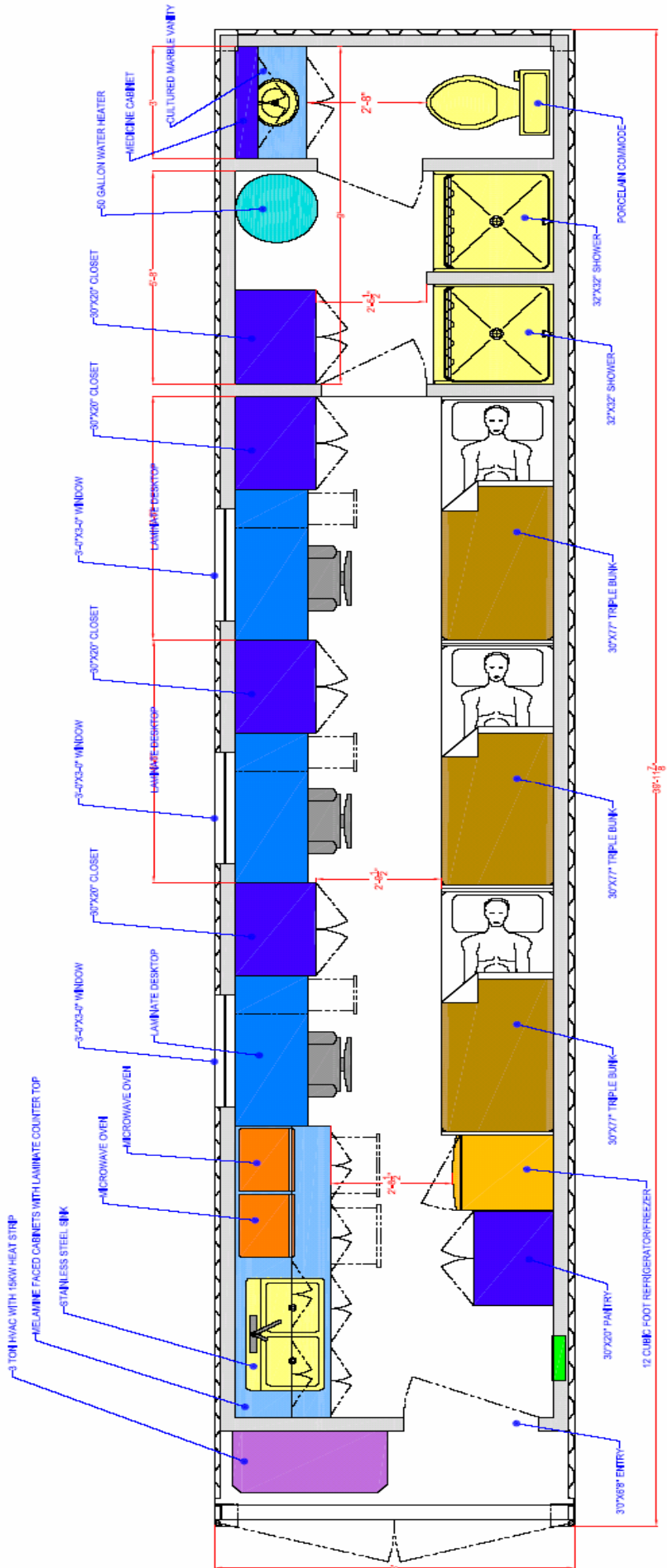

International Disaster Services
 713 Joe Tamplin Ind. Blvd.
 Macon, Georgia, U.S.A.
 Toll Free (866) 392-2674
 Local (478) 314-0750
 www.ids-disaster.com

CONFIDENTIAL
 The information herein is confidential business information and may not be copied or used for any purpose unless permission is expressly granted in writing by INTERNATIONAL DISASTER SERVICES, MACON, GEORGIA, USA

9 PERSON OFFICE WITH KITCHEN & BATH	
SIZE	CLIENT
B	
SCALE	NONE
TYPE	LAYOUT
SHEET	1 of 1



Six Person Barracks Disaster Relief Unit (DRU)

International Disaster Services



Features and Specifications

Features:

Specifications:

40' intermodal high cube container 40' x 8' x 9'6" (L x W x H)
Container is used unless specifically ordered new.

Exterior: Color: White
 Doors: Metal exterior doors

Insulation: Walls: R11
 Ceiling: R19
 Meets National Building Codes

Electrical: Wiring is Romex with solid conductors.
 All wiring meets current year National Electric Code regulations.

HVAC: 3 Ton HVAC with heat

Bunk units: 3 double fold up bunks
 Steel ladders for upper bunk access

The Six person barracks unit has three double fold-up bunks that sleep 6, three workstations equipped with data ports, storage drawers, three tall wardrobes, kitchen area with 2 microwaves, sink, refrigerator, 2 showers, 1 toilet and 1 sink. This unit is ideal for first responders that are also charged with administrative duties.



NOTE: This drawing has been produced by **IDS**. It is a custom design for **International Disaster Services**. This is not a finished drawing. These measurements are subject to change during manufacturing.

REVISIONS			
ZONE	REV	DESCRIPTION	DATE
			APPROVED

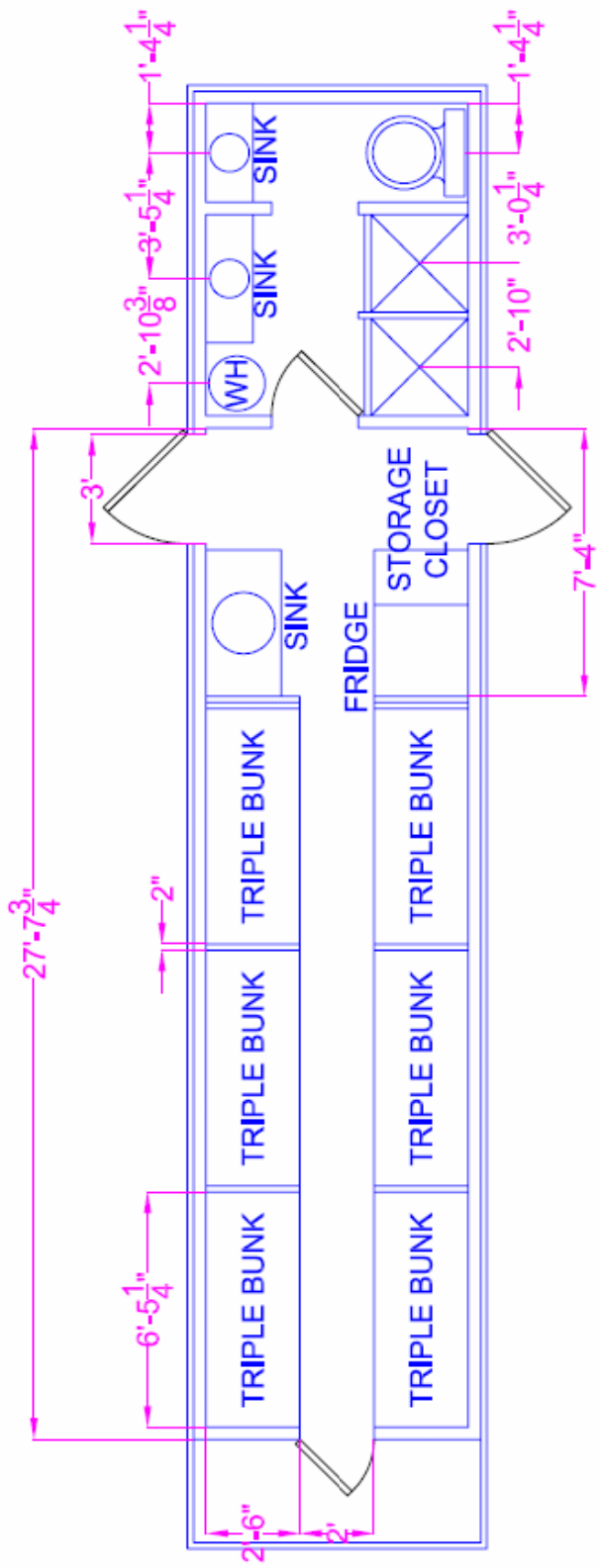

CONFIDENTIAL	International Disaster Services	
	18 PERSON UNIT	
The information herein is confidential business information and may not be copied or used for any purpose unless permission is expressly granted in writing by: INTERNATIONAL DISASTER SERVICES MACON, GEORGIA, USA		REV
SIZE A	FSCM NO.	DWG NO.
SCALE 3/16"=1'		SHEET 1 of 1



18 Person Bunkhouse Disaster Relief Unit (DRU)

International Disaster Services

The 18 person bunkhouse provides the necessities for quick response. This unit has sleeping quarters for 18 people, a kitchen area with microwave and refrigerator, sink, storage, 2 toilets and two showers.

Specifications and Features

Specifications and Features:

40' inter-modal high cube container 40' x 8' x 9'6" (L x W x H)

Container is used unless specifically ordered new.

Exterior: Color: White
 Doors: Metal exterior doors
Insulation: Walls: R11
 Ceiling: R19

Meets National Building Codes

Electrical: Wiring is Romex with solid conductors.
 All wiring meets current year National Electric Code regulations.

HVAC: 3 ton HVAC with heat
 Thermostat located in hallway. System serviceable from exterior of unit.

Bunk Units: 78" x 28" x 5" thick foam mattress
 Storage below each bunk
 Individual adjustable air vents
 120 volt AC receptacle
 Individual privacy curtains
 Finished with acoustical carpet
 Steel ladders for upper bunk access

Kitchen: Sink Shelf with microwave
 30" Frost Free Refrigerator
 Storage Cabinets

Bathroom: 2 Showers 3 Sinks
 Storage cabinet 2 toilets
 66 gallon quick recovery hot water heater



NOTE: This drawing has been produced by IDS. It is a custom design for International Disaster Services. This is not a finished drawing. These measurements are subject to change during manufacturing.

REVISIONS

ZONE	REV	DESCRIPTION	DATE	APPROVED

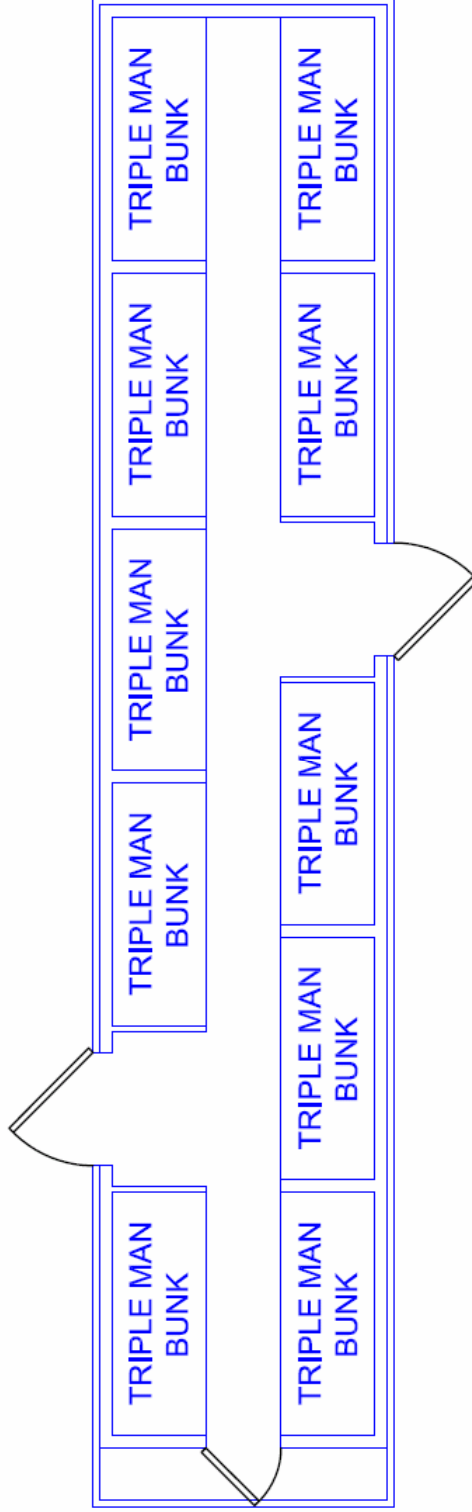

CONFIDENTIAL

The information hereon is confidential business information and may not be copied or used for any purpose unless permission is expressly granted in writing by:
INTERNATIONAL DISASTER SERVICES
 MACON, GEORGIA, USA



International Disaster Services

30 MAN UNIT

SIZE **A** FSCM NO. DWG NO. REV

SCALE **3/16"=1'**

SHEET

1 of 1



30 Man Bunkhouse Disaster Relief Unit (DRU)

International Disaster Services

The Bunkhouse unit is ideally suited to housing disaster work crews while they provide infrastructure repairs, rescue services, and clean up in the affected area. Each worker gets a comfortable bunk with individual air vent control, reading light, electrical outlet, and a boot shelf. Under each bunk is a 6 inch deep storage compartment where clothing and other essentials can be kept. A black privacy curtain helps keep light out so that the environment is conducive to sleep. The walls are carpeted so as to absorb light and sound. Three exits provide easy and quick egress once the shift starts. These units are often deployed in concert with shower and bathroom units.

Features and Specifications

Features: Ten triple bunks to sleep 30 people configured in a 40' high cube intermodal container.

Specifications:

40' intermodal high cube container 40' x 8' x 9'6" (L x W x H)

Container is used unless specifically ordered new.

Exterior: Color: White
 Doors: Metal exterior doors
Insulation: Walls: R11
 Ceiling: R19

Meets National Building Codes

Electrical: Wiring is Romex with solid conductors.
 All wiring meets current year National Electric Code regulations.

HVAC: 3 Ton HVAC with heat
 Thermostat located in hallway. System serviceable from exterior of unit.

Bunk Units: 78" x 28" x 5" (L x W x Thick) foam mattress
 Storage below each bunk.
 Individual adjustable air vents
 120 volt AC Receptacle
 Individual Privacy Curtain
 Finished with acoustical carpet
 Steel ladders for upper bunk access.



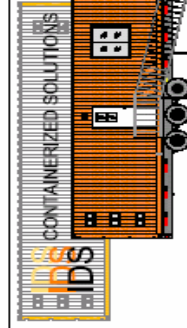
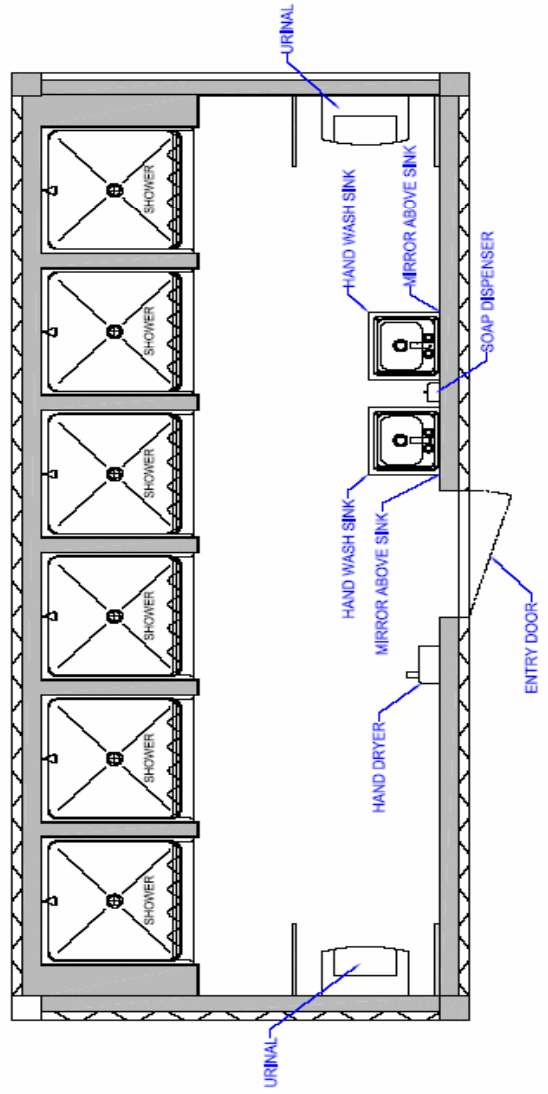
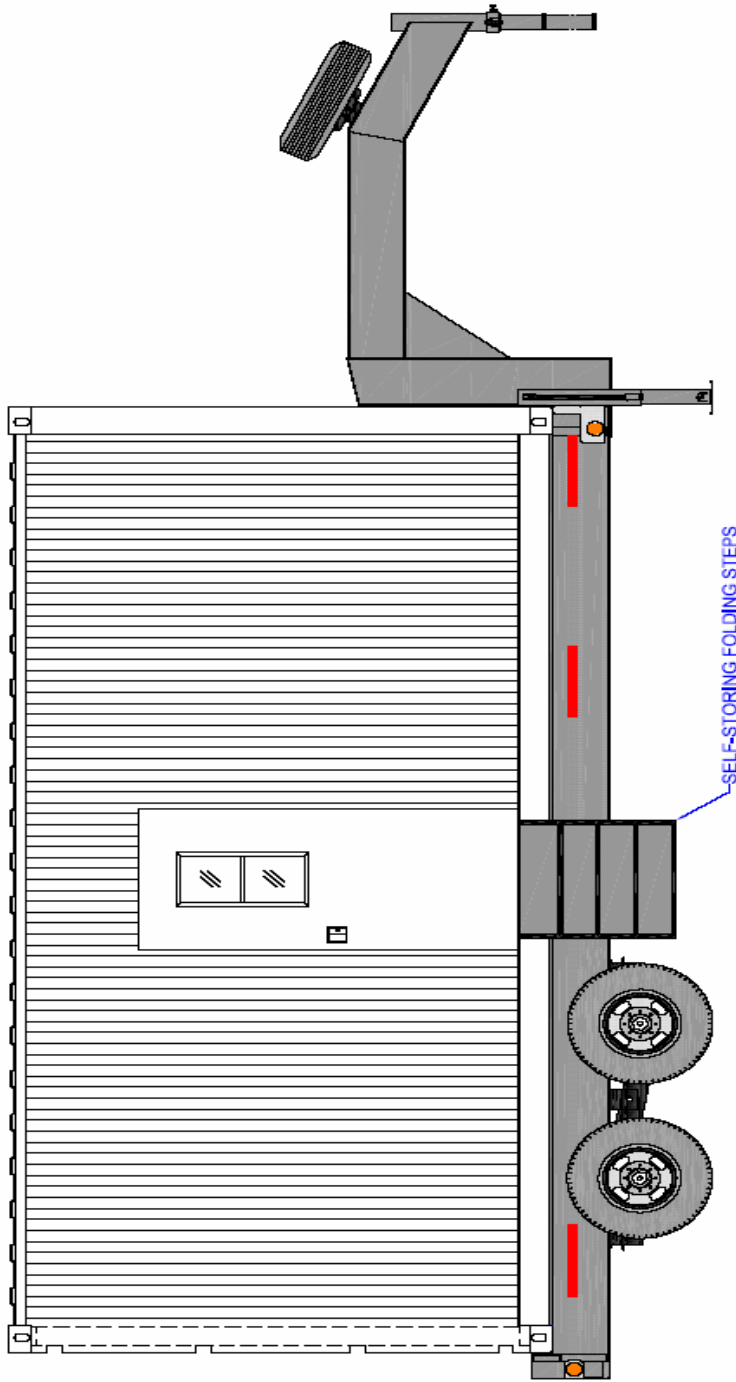

International Disaster Services
 703 Joe Templeton Ind. Blvd.
 Macon, Georgia, U.S.A.
 Toll Free (866) 392-4874
 Local (706) 314-0750
 www.intl-disaster.com

CONFIDENTIAL
 The information herein is confidential business information and may not be copied or used for any purpose unless permission is expressly granted in writing by:
INTERNATIONAL DISASTER SERVICES
 MACON, GEORGIA, USA

6 SHOWER - 20' MODULE

SIZE	CLIENT	IDS	REV
B			
SCALE	NONE	TYPE LAYOUT	SHEET 1 OF 1



Six Shower Disaster Relief Unit (DRU)

International Disaster Services

The six station shower unit is a companion to the popular Bunkhouse DRU. It is designed to allow personnel to shower, wash and otherwise clean themselves of the dirt and grime that most emergency workers must endure. After all, a place to sleep is only one part of rest for these hard working and selfless individuals.

The six station shower unit is designed to be self-sufficient with water, waste and electricity being the only connections required. Commercial quality mechanical systems are installed providing a high level of reliability. Individual shower stalls are constructed of reinforced fiberglass and are seamless allowing easy and thorough cleaning. Three-Compartment stainless steel sinks are installed complete with mirrors for shaving and washing. All interior embodiments are specifically designed for use in damp environments and are readily sanitized.

Features and Specifications

Features: Six shower stalls, two stainless steel sinks, polished stainless steel mirrors, instant on propane water heater, all surfaces covered in spray applied urethane sealer, making the unit highly resistant to steam and water vapor. Exhaust fans to vent water vapor and steam, and 1 ton HVAC with Heat

Specifications:

20' intermodal high cube container 20' x 8' x 8" (L x W x H)

Container is used unless specifically ordered new.

Exterior: Color: White
 Doors: Metal exterior doors
Insulation: Walls: R11
 Ceiling: R19

Meets National Building Codes

Electrical: Wiring is Romex with solid conductors.
 All wiring meets current year National Electric Code regulations.

Plumbing: PVC and CPVC Pipes

HVAC: 1 Ton HVAC with heat

Hot Water: Instant On Propane Water Heater.

Shower Units: 32" x 32" x 77" (L x W x H)
 Fiberglass construction with built in soap and shampoo shelves.

Mirrors: Indestructible Polished Stainless Steel

**Unit can be all showers or toilets. We also manufacture 40' Units.



NOTE: This drawing has been produced by IDS. It is a custom design for International Disaster Services. This is not a finished drawing. These measurements are subject to change during manufacturing.

REVISIONS

ZONE	REV	DESCRIPTION	DATE	APPROVED

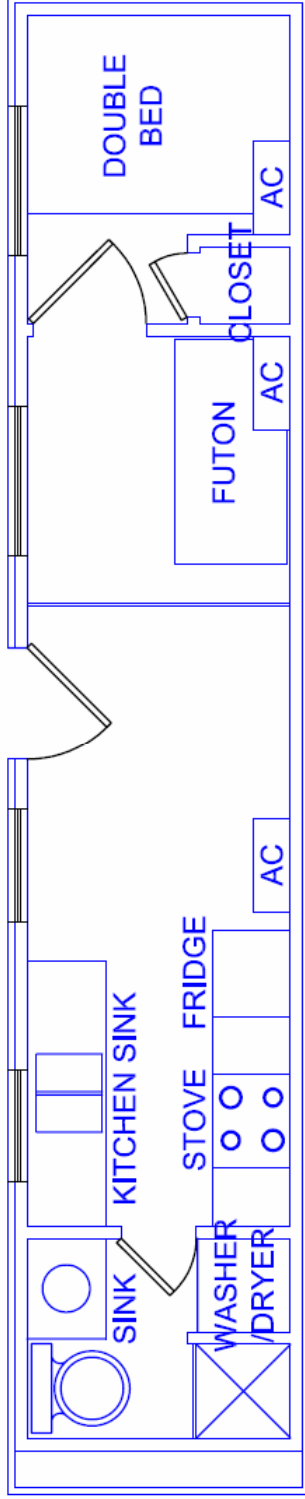

CONFIDENTIAL

The information hereon is confidential business information and may not be copied or used for any purpose unless permission is expressly granted in writing by:

INTERNATIONAL DISASTER SERVICES
MACON, GEORGIA, USA



International Disaster Services

RESIDENTIAL UNIT

SIZE **A** FSCM NO. DWG NO. REV

SCALE **3/16"=1'** SHEET **1 of 1**



Residential Disaster Relief Unit (DRU)

International Disaster Services

The Residential DRU is the International Disaster Services answer to the needs of the disaster victim in need of short term emergency housing during rebuilding and recovery efforts. Each unit is designed with the family in mind. A full service kitchen with refrigerator, full stove and microwave. Storage is provided by overhead and under sink cabinets. A split HVAC system provides cooling and heating with minimal interior impact. All surfaces are designed for ease of cleaning, and brightness.

Features and Specifications

Features:

Specifications:

40' intermodal high cube container 40' x 8' x 9'6" (L x W x H)

Container is used unless specifically ordered new.

Exterior:	Color:	White
	Doors:	Metal exterior doors
Insulation:	Walls:	R11
	Ceiling:	R19
		Meets National Building Codes
Electrical:	Wiring is Romex with solid conductors.	
	All wiring meets current year National Electric Code regulations.	
HVAC:	Cooling capacity: 36,000 BTU	
	Heating Capacity: 10,000 BTU	
	Thermostat located in hallway. System serviceable from exterior of unit.	
Windows:	Thermopane sliding windows	
	Egress certified	



NOTE: This drawing has been produced by **IDS**. It is a custom design for **International Disaster Services**. This is not a finished drawing. These measurements are subject to change during manufacturing.

REVISIONS

ZONE	REV	DESCRIPTION	DATE	APPROVED

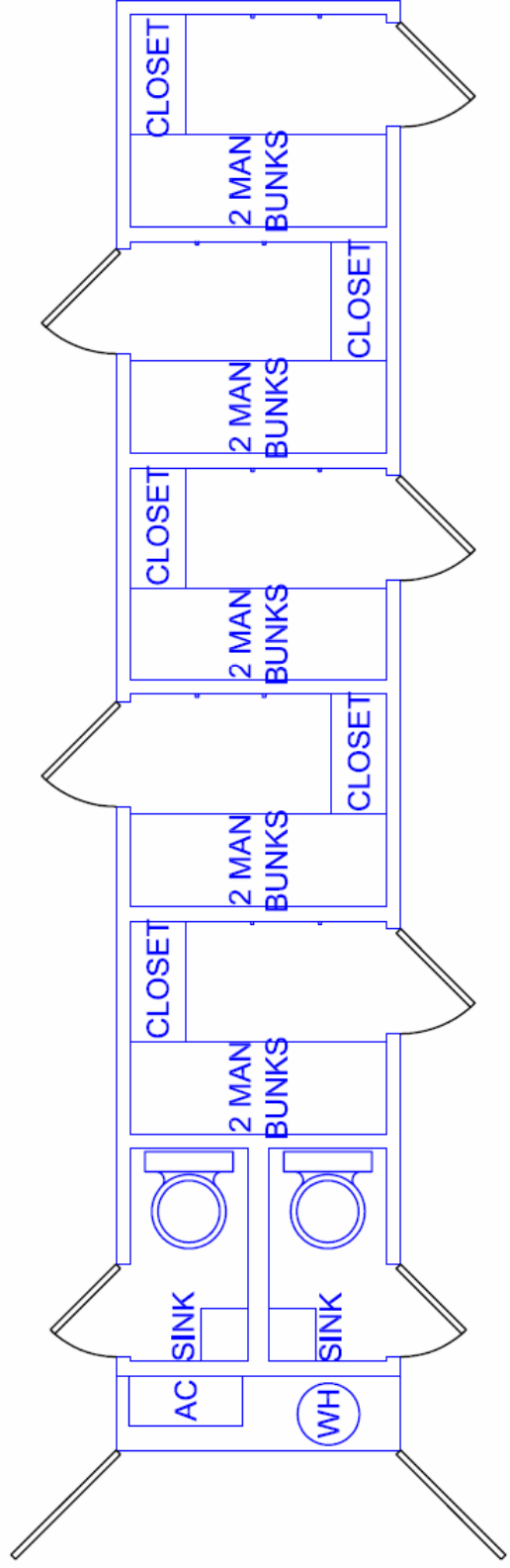

CONFIDENTIAL

The information hereon is confidential business information and may not be copied or used for any purpose unless permission is expressly granted in writing by:
Amusement Marketing Group
 LEE'S SUMMIT, MO, USA



International Disaster Services

10 PERSON BUNK HOUSE

SIZE	FSCM NO.	DWG NO.	REV
A			

SCALE 3/16"=1'	SHEET 1 of 1
-----------------------	---------------------



10 Person Bunkhouse (DRU)

International Disaster Services

The 10 Person Bunkhouse DRU is the International Disaster Services answer to the needs of first responders for short term emergency housing during rebuilding and recovery efforts. Each unit is designed with the 5 individual bunkrooms with a double bunk, wardrobe, and storage. Two separate shower rooms with sinks are installed at the rear of the unit. A split HVAC system provides cooling and heating with minimal interior impact. All surfaces are designed for ease of cleaning, and brightness.

Features and Specifications

Features:

Specifications:

40' intermodal high cube container 40' x 8' x 9'6" (L x W x H)

Container is used unless specifically ordered new.

Exterior: Color: White
 Doors: Metal exterior doors

Insulation: Walls: R11
 Ceiling: R19
 Meets National Building Codes

Electrical: Wiring is Romex with solid conductors.
 All wiring meets current year National Electric Code regulations.

HVAC: 3 Ton HVAC with heat
 Thermostat located in main bunkroom. System ser-viceable from exterior of unit.

Doors: Each door has 1/2 glass for natural light.
 Shower Door utilizes opaque glass.



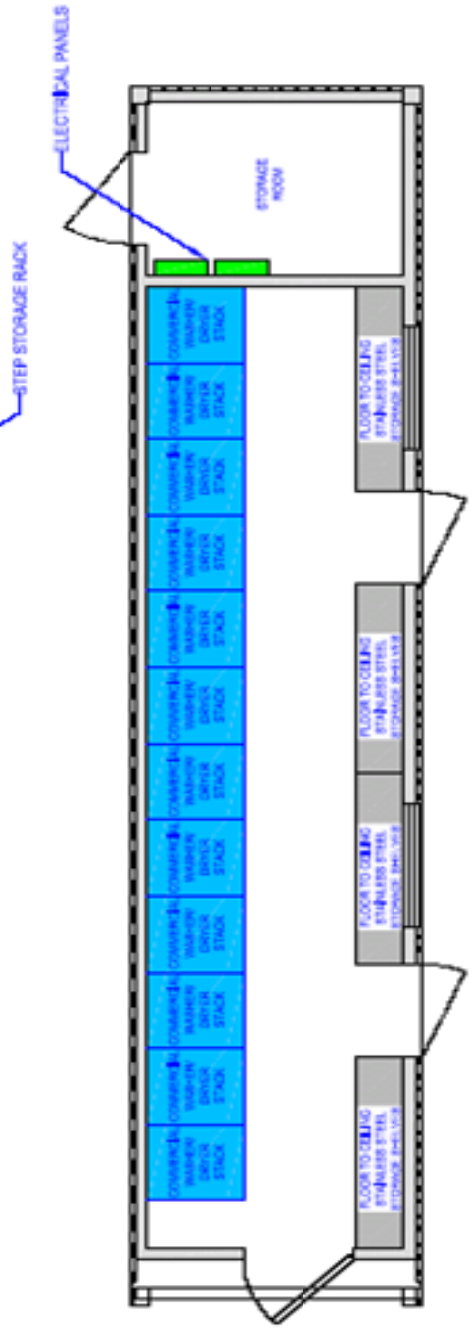
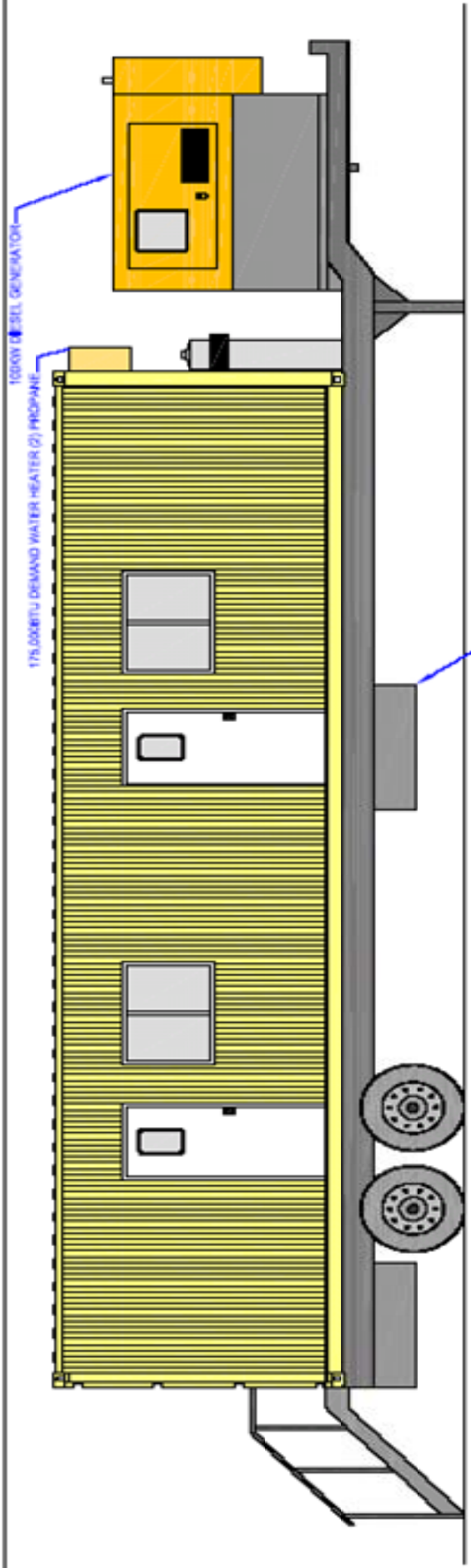

International Disaster Services
 703 Joe Taylor Blvd. #10
 States, Georgia, U.S.A.
 Toll Free (888) 383-2874
 Local (478) 314-0719
www.ids-disaster.com

CONFIDENTIAL
 This document is confidential and may not be copied or used for any purpose without written permission from International Disaster Services, Inc.
www.internationaldisastersolutions.com
 MACON, GEORGIA, USA

40' COMMERCIAL LAUNDRY UNIT WITH GENERATOR

AGE	SIZE	TYPE	LAYOUT	SCALE	DATE	REV
B	40'	NONE	IDS	NONE	1/10/11	1 of 1



Washer Dryer (DRU)

International Disaster Services

The Washer Dryer DRU is the International Disaster Services answer for large capacity clothes washing in emergencies as well as day to day needs. Each unit is designed with the 12 commercial washers and dryer units, 4 ventilation fans, Stainless folding counter and shelving. All surfaces are designed for ease of cleaning, and brightness.

Features and Specifications

Features:

Specifications:

40' intermodal high cube container 40' x 8' x 9'6" (L x W x H)

Container is used unless specifically ordered new.

Exterior: Color: White
 Doors: Metal exterior doors

Insulation: Ceiling: R19

 Meets National Building Codes

Electrical: Wiring is Romex with solid conductors.
 All wiring meets current year National Electric Code regulations.

HVAC: 2 ventilation fans

Doors: Each door has 1/2 glass for natural light.

Windows: Unit comes with 4 windows for natural light.

Water Heat: (2) Instant On Propane Water Heaters



NOTE: This drawing has been produced by **IDS**. It is a custom design for International Disaster Services. This is not a finished drawing. These measurements are subject to change during manufacturing.

REVISIONS

ZONE	REV	DESCRIPTION	DATE	APPROVED

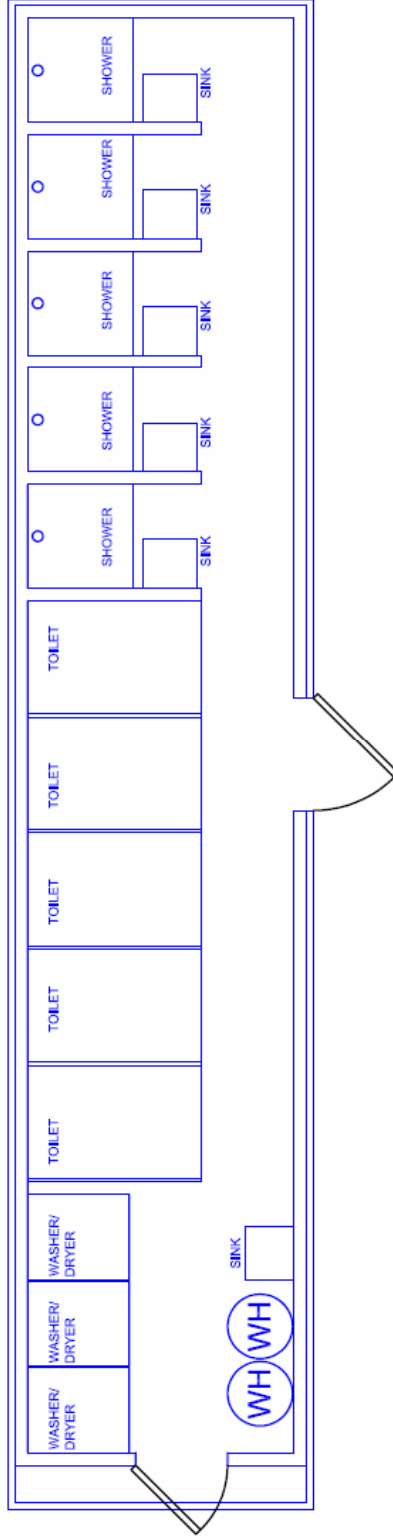

CONFIDENTIAL

The Information hereon is confidential business information and may not be copied or used for any purpose unless permission is expressly granted in writing by:
INTERNATIONAL DISASTER SERVICES
 MACON, GEORGIA, USA



International Disaster Services

WASH AND GO UNIT

SIZE	FSCM NO.	DWG NO.	REV
A			
SCALE 3/16"=1'		SHEET	1 of 1



Wash n Go (DRU)

International Disaster Services

The Wash n Go DRU is the International Disaster Services answers three basic utility needs in one unit. The unit consist of 5 toilets, 5 showers with hand sinks, and 3 washer dryer stacks. All surfaces are designed for ease of cleaning, and brightness.

Features and Specifications

Features:

Specifications:

40' intermodal high cube container 40' x 8' x 9'6" (L x W x H)

Container is used unless specifically ordered new.

Exterior: Color: White
Doors: Metal exterior doors

Insulation: Walls: R11
Ceiling: R19
Meets National Building Codes

Electrical: Wiring is Romex with solid conductors.
All wiring meets current year National Electric Code regulations.

HVAC: 3 Ton HVAC system with heat.

Doors: Each door has 1/2 glass for natural light.



EXTERIOR EQUIPMENT LIST

1. REAR ENTRY STEPS WITH HANDRAILS
2. TABLE HALOGEN LIGHT (RECESSED)
3. UNDERCOUNTER STORAGE BOX
4. MANUAL AIRING
5. REAR ENTRY STEPS WITH HANDRAILS
6. GREEN STROBE BEACON
7. ENTRY LIGHT
8. 24"X36" STEEL ENTRY DOOR
9. FOLDUP PLATFORM & HANDRAILS
10. 24"X36" PASS THROUGH WINDOW
11. FOLDUP STORM SHUTTER
12. 3 TON HVAC UNIT
13. 200V BEBEL GENERATOR IN ENCLOSURE
14. SPARE TIRE

INTERIOR EQUIPMENT LIST

1. REAR ENTRY STEPS
2. REAR STORAGE AREA
3. EXTERIOR VIDEO MONITOR
4. CONFERENCE AREA VIDEO MONITOR
5. LAMINATED CONFERENCE TABLE WITH DATA PORTS
6. CONFERENCE AREA CHAIRS
7. DRY ERASE BOARD
8. POCKET DOOR WITH WINDOW
9. UNDERCOUNTER BEBEL GENERATOR
10. COUNTERTOP MIRRORWAY
11. FULL HEIGHT STORAGE CABINET
12. POCKET DOOR
13. 30" HIGH STORAGE CABINET W/ DRAWERS
14. LED VIDEO MONITOR
15. 3 TON HVAC WITH/OUT ELECTRIC HEAT
16. 30" STEEL ENTRY DOOR WITH WINDOW
17. DRY ERASE BOARD
18. VIDEO ENTRY STEPS (IN REAR)
19. 30" STEEL ENTRY DOOR WITH WINDOW
20. STEEL MESH FOLDING PLATFORM X 21"
21. 24"X36" PASS THROUGH WINDOW THERMOPANE
22. MANUAL FOLD STYLE AIRING
23. 30" HIGH LAMINATE WORK SURFACE
24. 30" HIGH LAMINATE WORK SURFACE
25. RECESSED DATA POWER PORTS (R)

FINISHES & COLORS

1. MEDIUM GRAY URETHANE LAMINATE FLOOR, WALLS, CEILING
2. MEDIUM GRAY URETHANE LAMINATE FLOOR, WALLS, CEILING
3. GRAY MATRIX-HIGH PRESSURE LAMINATE
4. BLACK LEATHER
5. MEDIUM GRAY URETHANE LAMINATE FLOOR, WALLS, CEILING
6. MEDIUM GRAY URETHANE LAMINATE FLOOR, WALLS, CEILING
7. GRAY MATRIX-HIGH PRESSURE LAMINATE
8. BLACK LEATHER

ITEMS NOT SHOWN

- INTERIOR FLUORESCENT LIGHTING THROUGHOUT
- SMOKE/CO2 DETECTORS IN EACH SPACE
- READY BOX MOUNTING
- DATA PORTS THROUGHOUT (BY TOTAL)
- RECEPTACLES THROUGHOUT (BY TOTAL)
- LIGHT SWITCHES THROUGHOUT FOR INT. & EXT. FUNCTIONS
- HVAC THERMOSTAT
- COAT HOOKS (2)

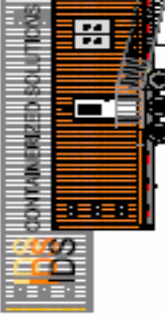
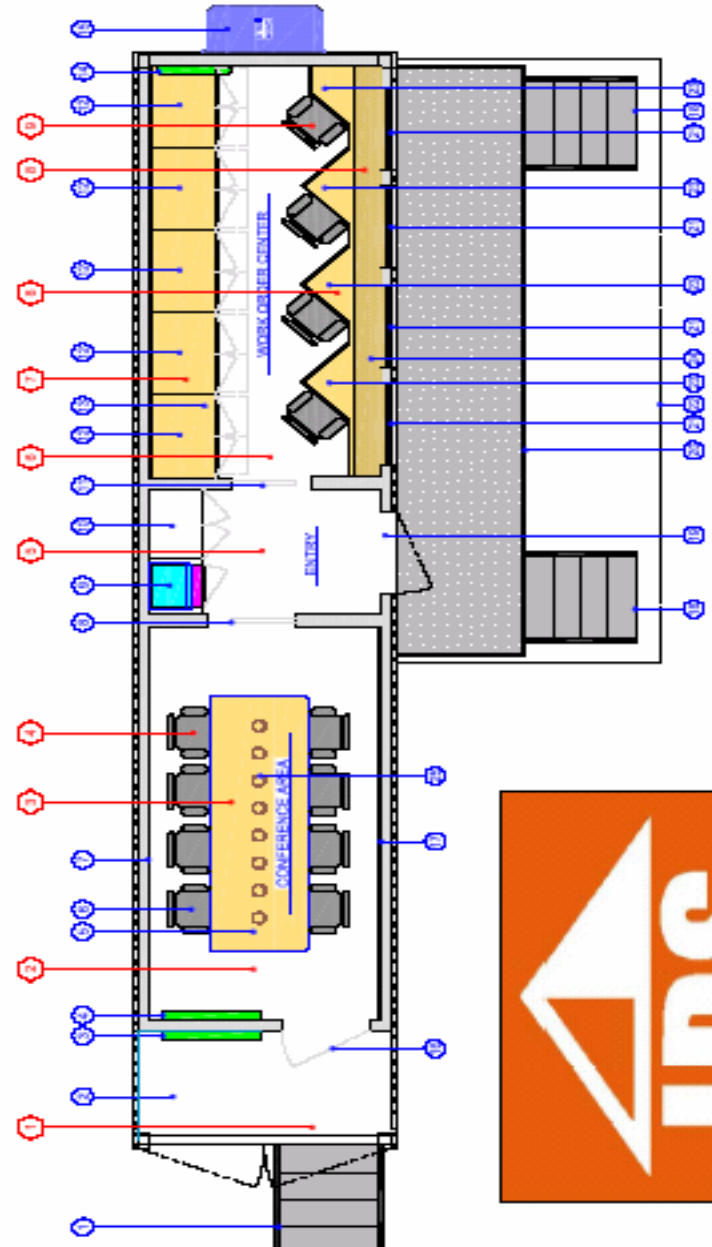
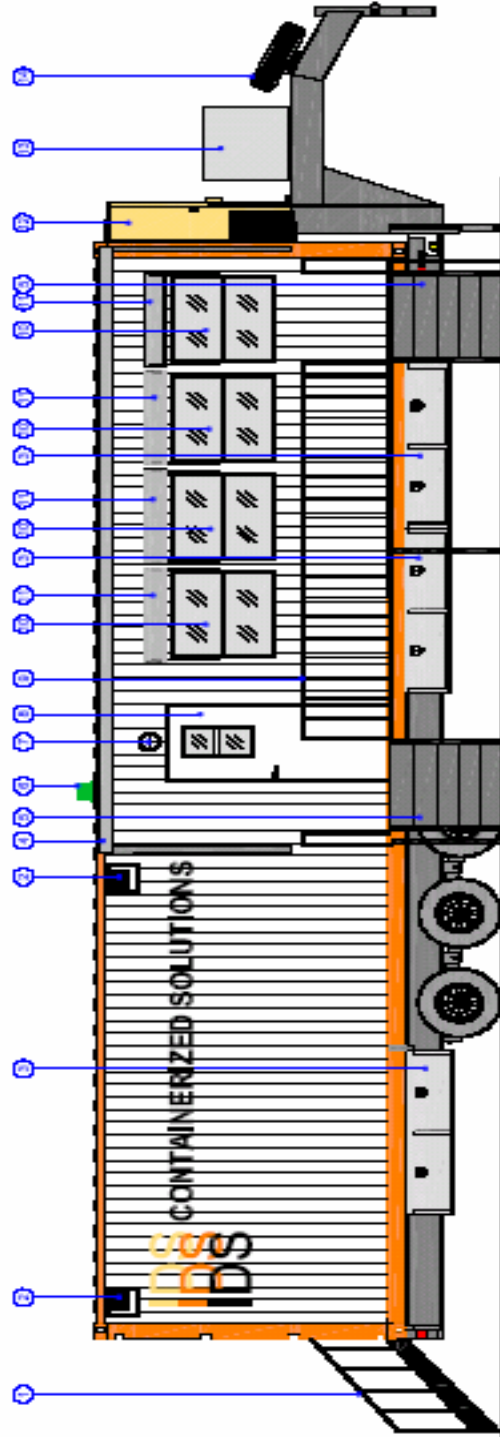

International Disaster Services
 700 Lee Street, Inc. Bldg.
 Macon, Georgia, U.S.A.
 Tel: (478) 534-8100
 Fax: (478) 534-8101
 Email: ids@ids.com
www.ids.com

CONFIDENTIAL
 The information herein is confidential and its use for any purpose other than that intended is prohibited without the written consent of IDS.
 Made in the U.S.A.
 MACON, GEORGIA, USA

COMMAND CENTER

NO. B	CLINT	SCALE	NONE	TYPE LAYOUT	SHEET
					1 of 1



Mobile Command (DRU)

International Disaster Services

The Mobile Command DRU is the International Disaster Services mobile custom conference and communications center. The unit comes with meeting table, 5 desk, full bathroom, and galley style kitchen. All surfaces are designed for ease of cleaning, and brightness. The exterior of the unit comes with retractable awning, exterior lights, and outside storage boxes

Features and Specifications

Features:

Specifications:

40' intermodal high cube container 40' x 8' x 9'6" (L x W x H)
Container is used unless specifically ordered new.

Exterior: Color: White
 Doors: Metal exterior doors

Insulation: Walls: R11
 Ceiling: R19
 Meets National Building Codes

Electrical: Wiring is Romex with solid conductors.
 All wiring meets current year National Electric Code regulations.

HVAC: 3 Ton HVAC system with heat.

Doors: Each door has 1/2 glass for natural light.

**Contact an IDS Representative to discuss options needed for your customized IDS Command Center.





Dorm with 2 Bath (DRU)

International Disaster Services

The Dorm with 2 Bath DRU is the International Disaster Services dormitory style unit with individual bathrooms. Each dorm room has a single bed, small galley kitchen, desk with cabinets and full bathroom. All surfaces are designed for ease of cleaning, and brightness.

Features and Specifications

2 Person Living Quarters

40' Refurbished ISO Container painted in owner's choice of colors

(2) 3068 exterior personnel doors with view window

(2) 4030 horizontal slide windows with blinds

Each room of the unit will contain:

1 Ton HVAC system with heat.

Full Size bed with under bed storage

Chair

Fold out table

Desk with Chair

3 Upper storage cabinets

Wardrobe Closet

2 Mini Refrigerators

1 Microwave

16"x 3' Shelf over HVAC

Each Bathroom will contain:

Standard Toilet

Vanity with Stainless sink and faucet

Corner Shower with Sliding Door

Medicine Cabinet

Towel bar and toilet paper dispenser

3068 personnel door with hardware

Floor Drain

Floor will be raised 10"

R19 fiberglass insulation in ceiling of unit

R11 fiberglass insulation in walls of unit

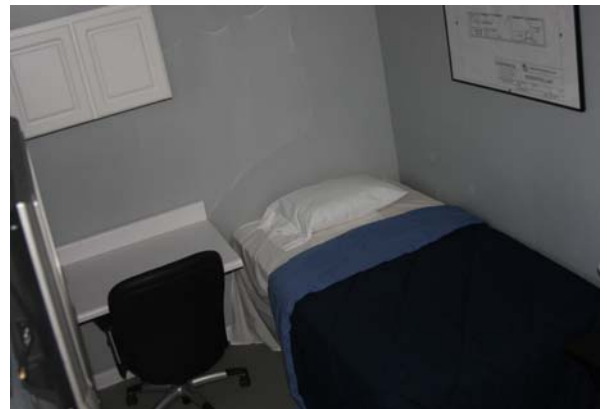

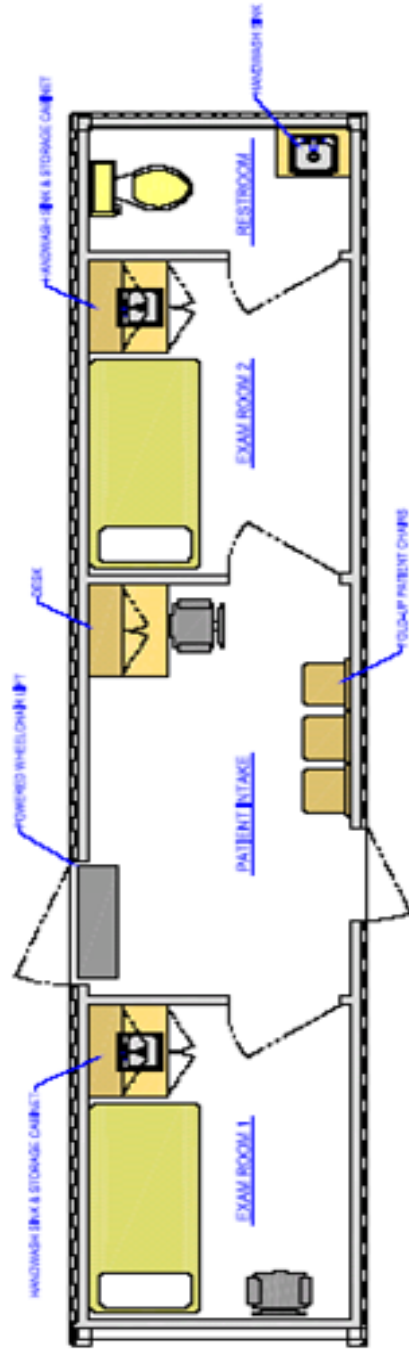
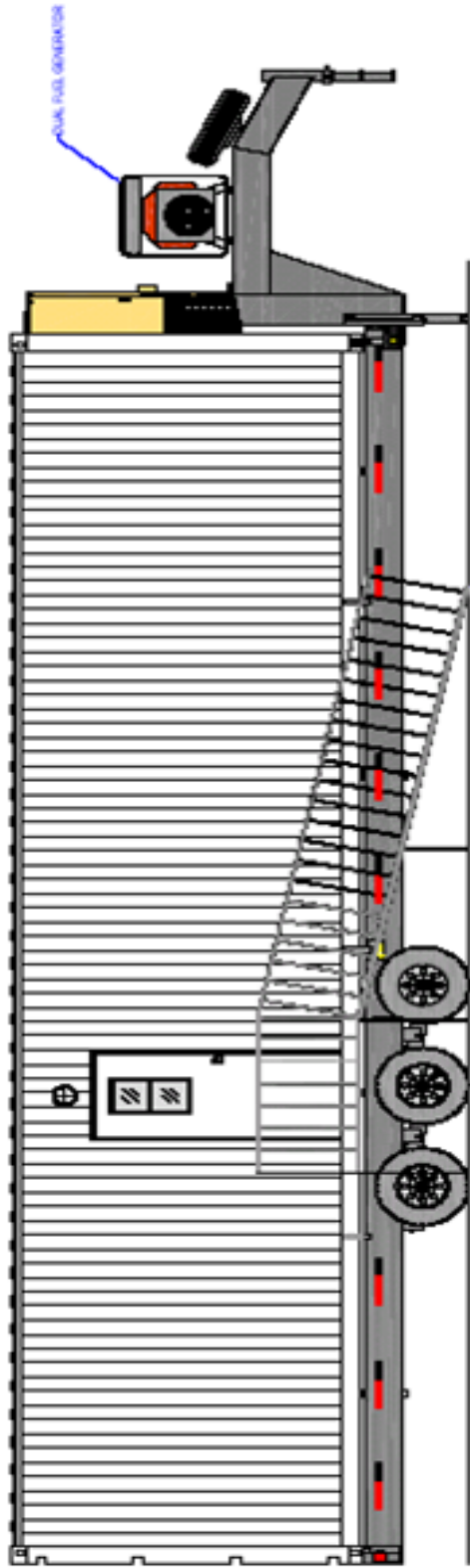

International Disaster Services

750 Ave. Tower Dr. #146
 Marietta, Georgia, U.S.A.
 Tel: +1 (770) 382-0874
 Local: (478) 314-0779
 www.ids-disaster.com



MEDICAL EXAM UNIT
 A.D.A. COMPLIANT

CONFIDENTIAL

The information herein is confidential and may not be used or copied for any purpose without the express written permission of International Disaster Services, Inc. © 2011

IDS CLIENT

I.D.S.

REV

REV

NONE

LAYOUT 1

SHEET

1 of 1



Medical Exam (DRU)

International Disaster Services

The Mobile Exam DRU is the International Disaster Services mobile medical unit for quick response to disasters as well as a mobile facility for remote locations. The unit comes with 2 exam rooms, waiting area, full bathroom, washer/dryer unit, and a handicapped entry. All surfaces are designed for ease of cleaning, and brightness. The exterior of the unit comes with retractable awning, exterior lights, and outside storage boxes.

Features and Specifications

Features:

Specifications:

40' intermodal high cube container 40' x 8' x 9'6" (L x W x H)

Container is used unless specifically ordered new.

Exterior:	Color:	White
	Doors:	Metal exterior doors
Insulation:	Walls:	R11
	Ceiling:	R19
		Meets National Building Codes
Electrical:	Wiring is Romex with solid conductors.	
	All wiring meets current year National Electric Code regulations.	
HVAC:	3 Ton HVAC system with heat.	
Doors:	Each door has 1/2 glass for natural light.	



NOTE: This drawing has been produced by **IDS**. It is a custom design for **International Disaster Services**. This is not a finished drawing. These measurements are subject to change during manufacturing.

REVISIONS

ZONE	REV	DESCRIPTION	DATE	APPROVED

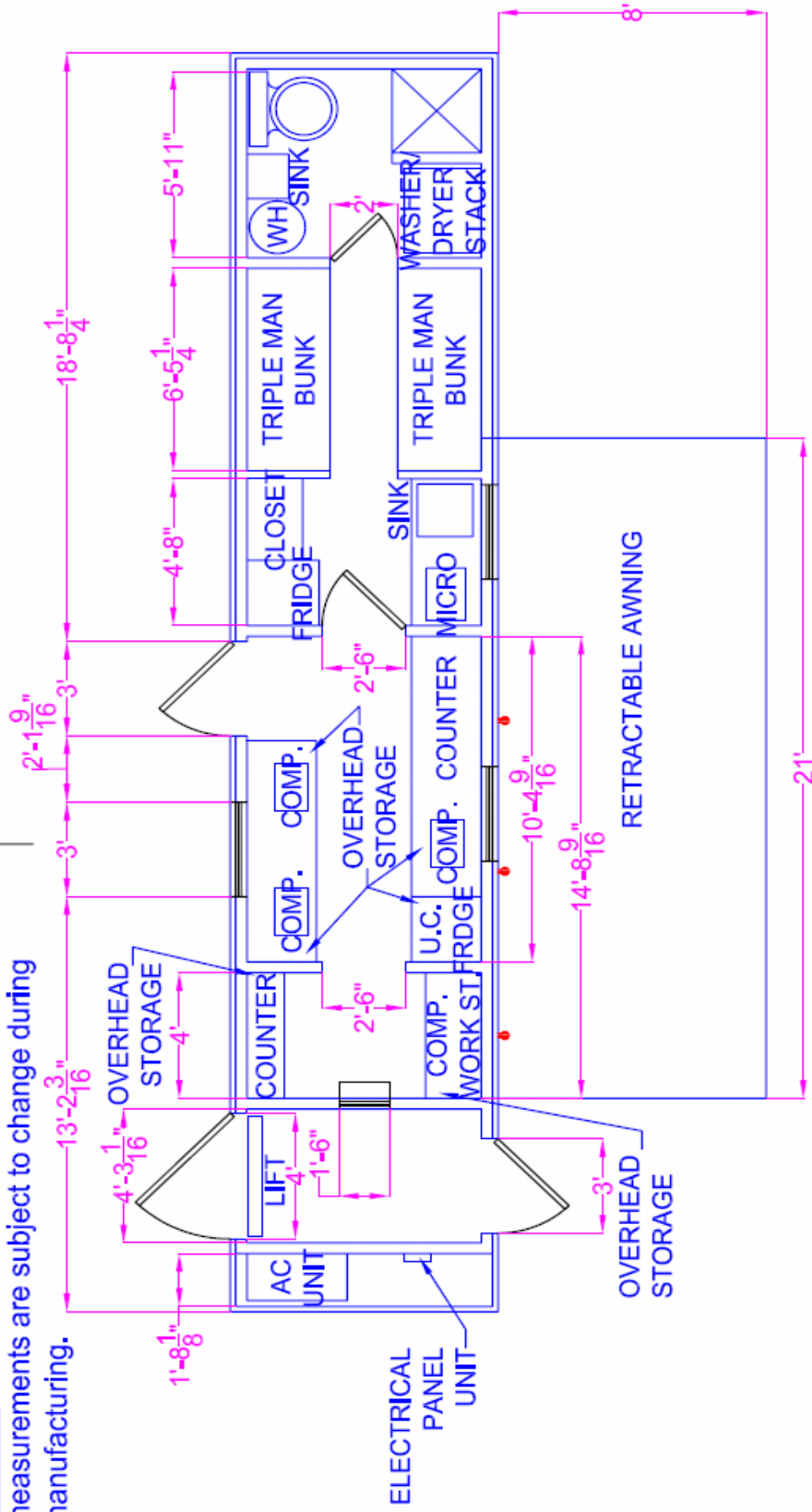

CONFIDENTIAL

The Information hereon is confidential business information and may not be copied or used for any purpose unless permission is expressly granted in writing by:

INTERNATIONAL DISASTER SERVICES
MACON, GEORGIA, USA

IDS International Disaster Services

MOBILE PHARMACY

SIZE	FSCM NO.	DWG NO.	REV
A			

SCALE 3/16"=1' SHEET 1 of 1



Mobile Pharmacy (DRU)

International Disaster Services

The Mobile Command DRU is the International Disaster Services mobile custom conference and communications center. The unit comes with meeting table, 6 desk, full bathroom, and galley style kitchen. All surfaces are designed for ease of cleaning, and brightness. The exterior of the unit comes with retractable awning, exterior lights, and outside storage boxes

Features and Specifications

Features:

Specifications:

40' intermodal high cube container 40' x 8' x 9'6" (L x W x H)

Container is used unless specifically ordered new.

- | | | |
|-------------|---|-------------------------------|
| Exterior: | Color: | White |
| | Doors: | Metal exterior doors |
| Insulation: | Walls: | R11 |
| | Ceiling: | R19 |
| | | Meets National Building Codes |
| Electrical: | Wiring is Romex with solid conductors. | |
| | All wiring meets current year National Electric Code regulations. | |
| HVAC: | 3 Ton HVAC system with heat. | |
| Doors: | Each door has 1/2 glass for natural light. | |





Base Camps

International Disaster Services

International Disaster Services offers numerous designs for Base Camp Operations. IDS Base Camps can be configured to be self contained with individual bunkrooms, kitchen and dining facilities, recreation rooms, and restrooms. The camp can be configured with generator power and fresh and black water holding tanks.

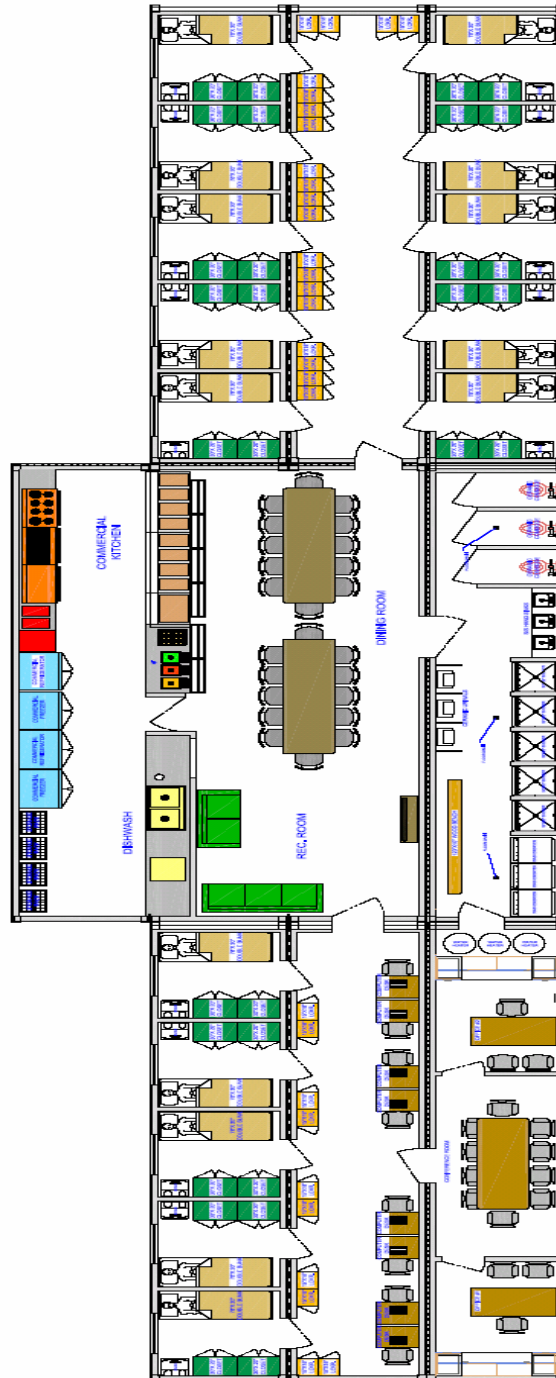

International Disaster Services
 770 Joe Trough Ind Blvd.
 Marietta, Georgia, U.S.A.
 30067-1404
 Local (404) 344-0279
www.ids-usa.com

30 MAN BASE CAMP	
<p>CONFIDENTIAL This information is confidential and is not to be distributed or used for any purpose other than that intended by International Disaster Services, Inc. without the express written consent of International Disaster Services, Inc. (MARIETTA, GEORGIA, U.S.A.)</p>	<p>CLIENT: HUFFMASTER SCALE: NONE SHEET: 1 OF 1</p>





Misc. Utility Units

International Disaster Services

International Disaster Services offers numerous designs for Utility Units. These units include Water Holding Containers, Sewage Treatment Containers and Power Generation Containers..

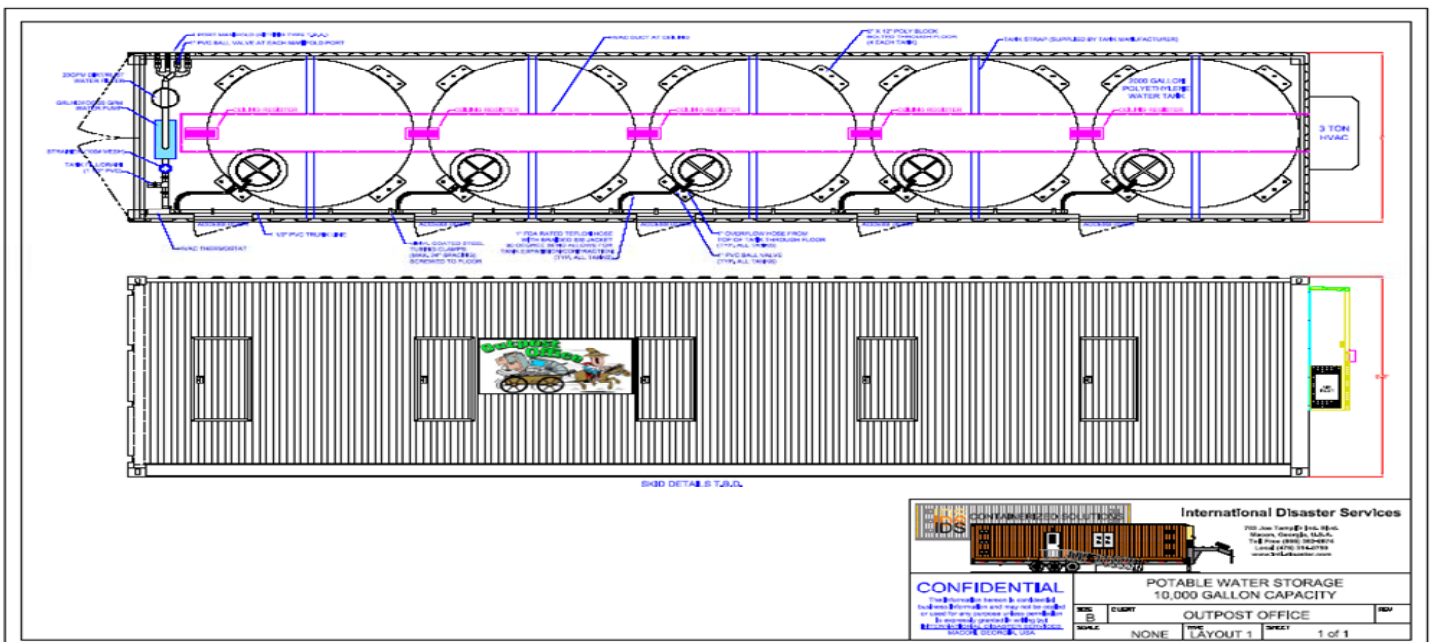
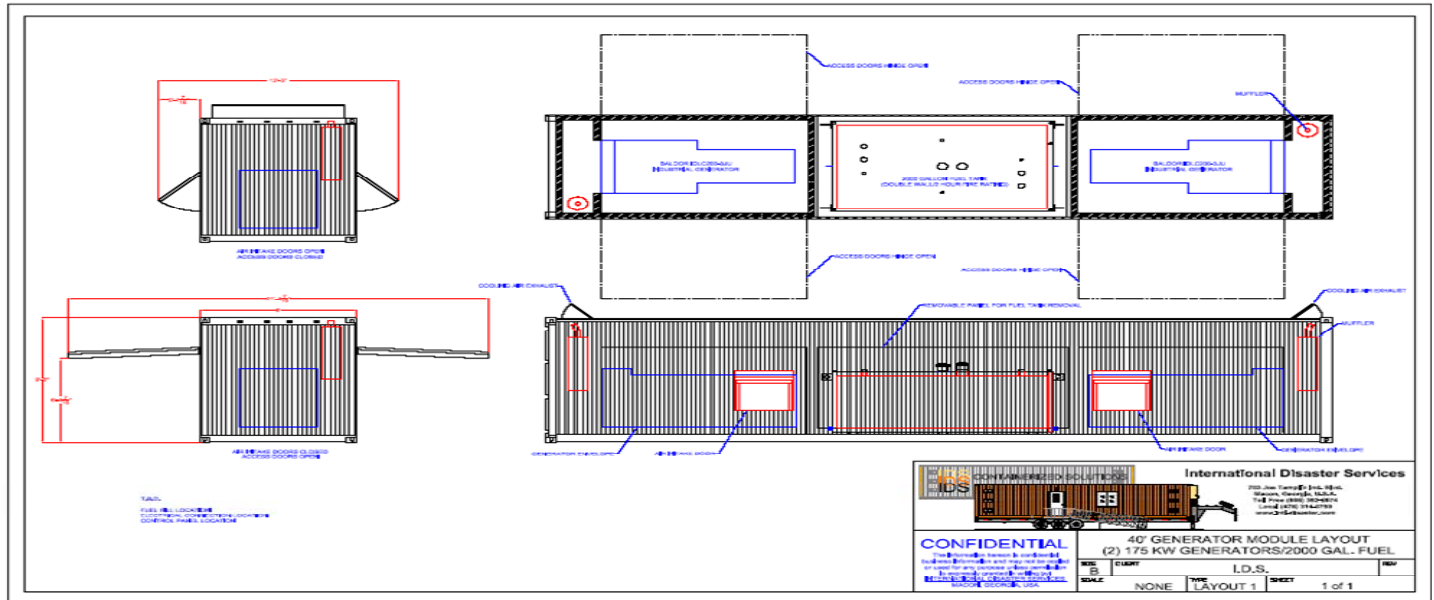



Correctional (DRU)

International Disaster Services

International Disaster Services offers a full line of correctional type facilities. These units consist of 4 person lock-down cells to correctional restroom units. These units are built to Correctional standards and are durable and tamperproof.

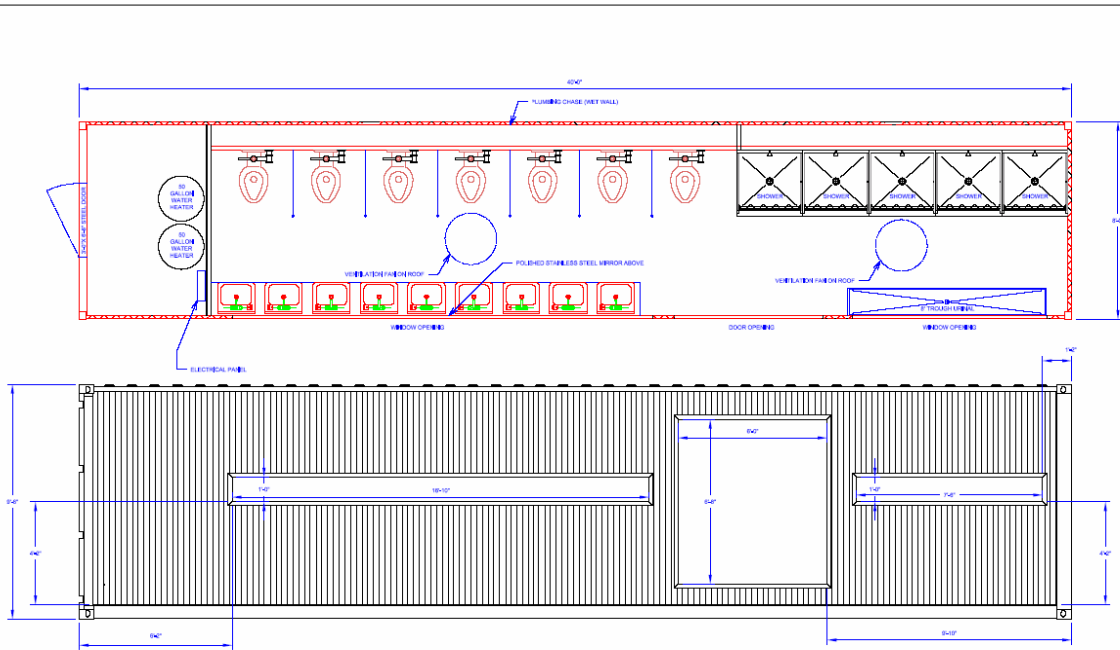

CONFIDENTIAL

IDS International Disaster Services

The information herein is confidential business information and may not be copied or used for any purpose without permission. It is expressly granted in writing to:

INTERNATIONAL DISASTER SERVICES
MADISON, GEORGIA, USA

SIZE	CLIENT	REV
B	PROTEUS	
SCALE	TITLE	SHEET
NONE	LAYOUT	1 of 1





Hurricane Shelters Ballistic/Blast Proof Units

International Disaster Services

All of the IDS Product line can be up fitted to help the unit withstand Hurricane Force winds or Ballistic and Blast Proof Capabilities. Contact an IDS representative to help with the design of a containerized solution for your needs.

